

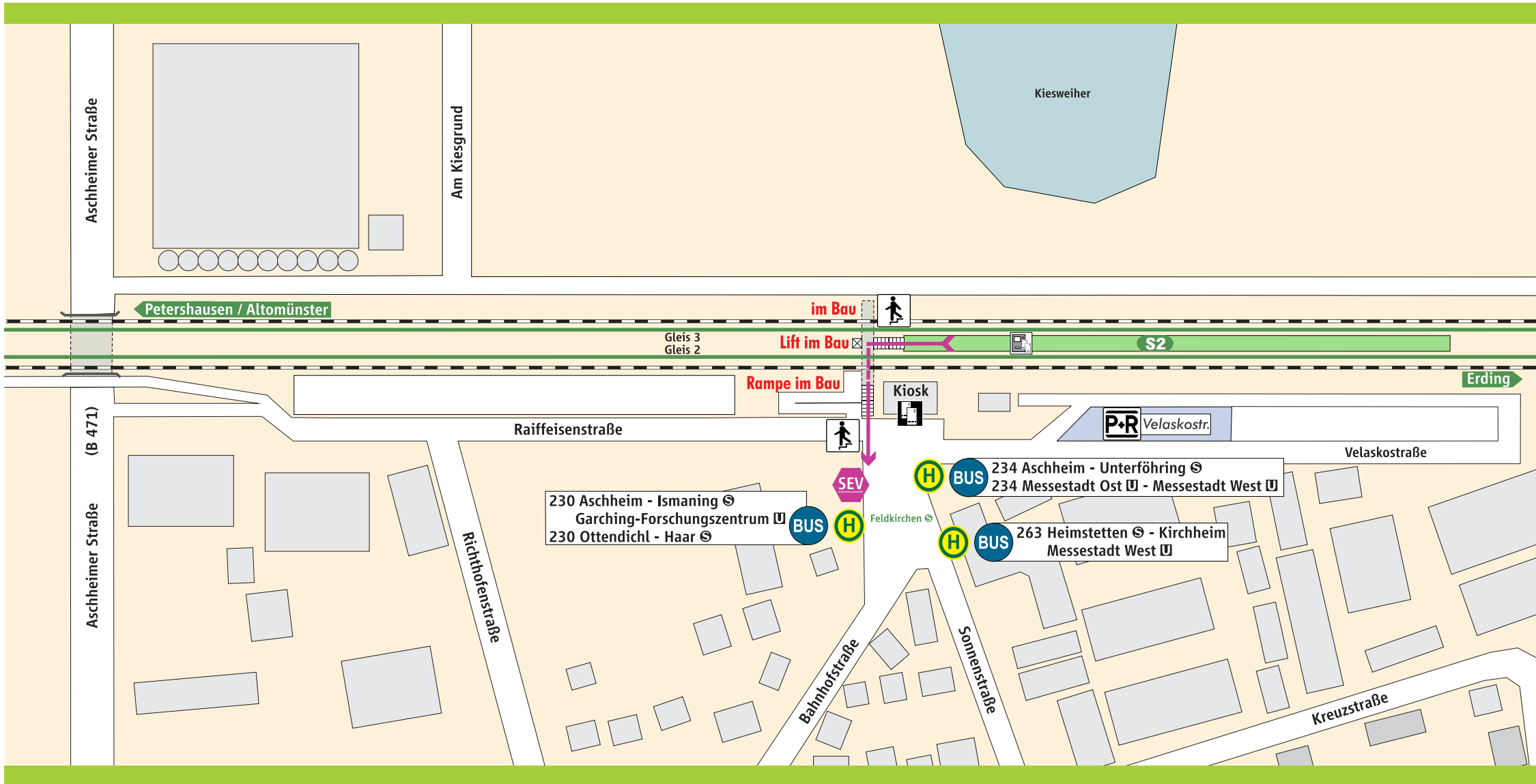





Feldkirchen



-  S-Bahnsteig
-  **P+R** Parkplatz
-  Treppe
-  Fahrkartenautomat
-  Behinderten-Parkplatz
-  Fahrkartenverkauf
-  Fahrrad-
ständer

Schienenersatzverkehr

 **Schienenersatzverkehr**

➔ **Fußweg ca. 2-4 Min.**